

How to use the Epson Ceiling Mounted Projector

- 1 Tap the **AV Equipment** button on the Cisco touch panel. Toggle **Projector power** to ON.

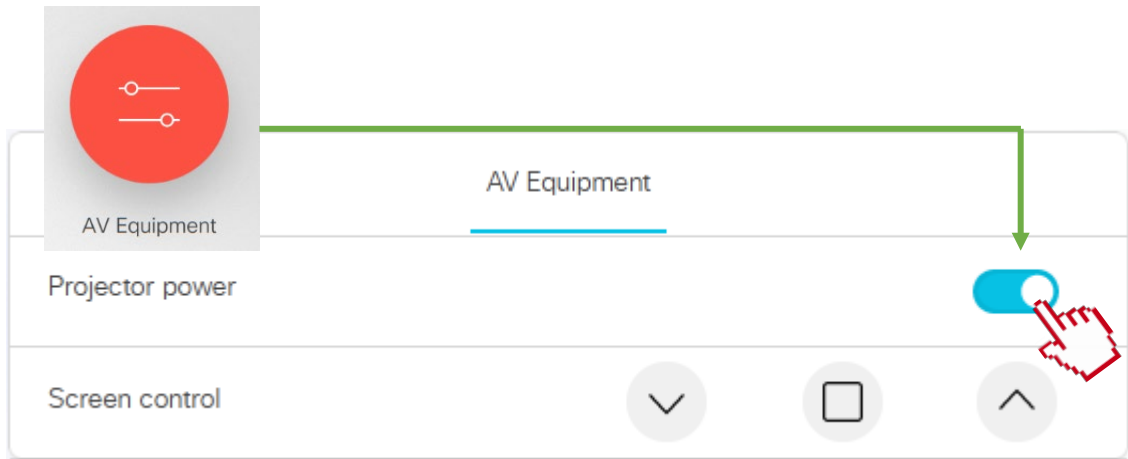

- 2 Connect your PC to the HDMI cable at the podium using the USB-C adapter if necessary.

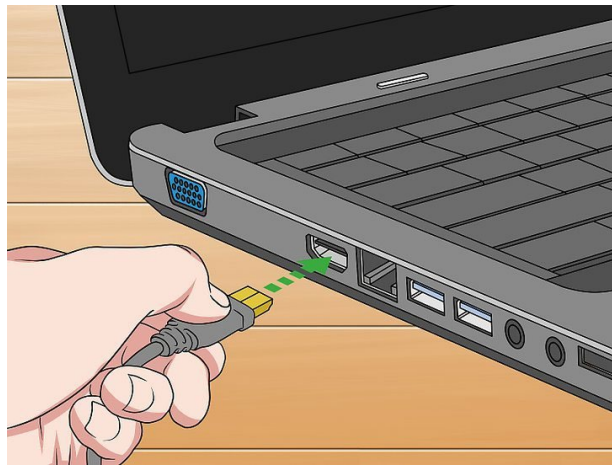

Note: Cisco Proximity is also available for wireless screen sharing.



PLEASE TURN OFF SYSTEM AFTER USE

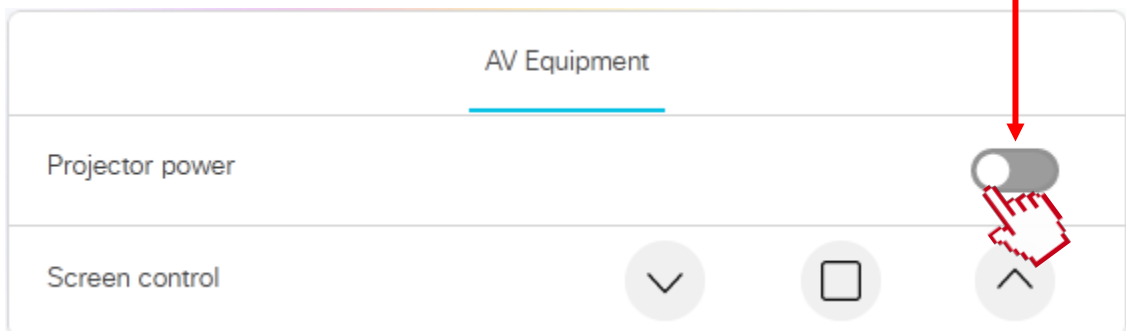

For detailed instructions of this system please refer to the manual located at the control desk. Contact AV Services at av@oist.jp or 21534, to request assistance or report a fault.